



APPLICATION

MGM Model 301 Excess Flow Check Valves are designed for use in threaded tank nozzles. They are made completely of carbon and stainless steel. Bodies are machined from bar stock, not castings, for added durability.

Model 301 Excess Flow Check Valve has male pipe thread on the bottom end. The valve can be mounted in any orientation with negligible effect on flow rate. As with all MGM excess flow check valves, Model 301 is equipped with an orifice in the check mechanism to allow for pressure equalization and will reopen automatically after repairs are made.

FEATURES

- Valve will slip inside Schedule 80 or less steel pipe.
- Valve is designed to be threaded into tank nozzle. A 1/4" notch is provided to ease installation.
- Generous flow channels provide minimal pressure drops.
- Heavy duty steel construction will withstand temperatures from -50° F (-45° C) to +300° F (+148° C) and internal pressures up to 3000 psig (207 barg).
- Complete stainless steel construction available for greater range of operating temperatures.

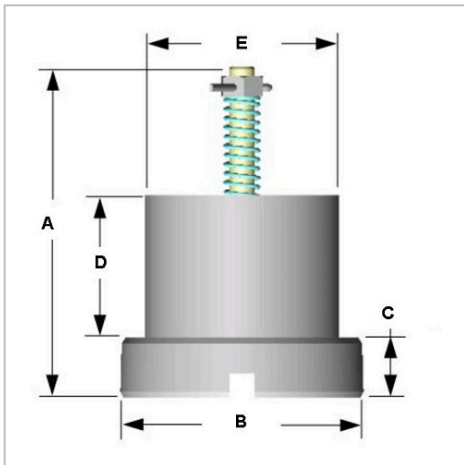

FLOW RATINGS

See the table below for flow rates for common fluids. Please contact MGM to choose the proper spring for your specific application.

STANDARD MATERIALS

	Carbon Steel	316 Stainless
Body	Low-temp Carbon	316-SS
Guide	Low-temp Carbon	316-SS
Spring	--- 316- or 302-SS ---	
Poppet (incl. nut and cotter pin)	--- 316-SS ---	

PRODUCT CERTIFICATIONS



Canadian Registration Number
OC13500.5C



CE Mark Certified to Pressure
Equipment Directive 2014/68/EU

Model Number	Pipe Size	Available Closing Flow Ranges Approx. Flow in GPM Liquid*		Dimensions (Inches)				
		Propane	Ammonia	A - Open	B-MNPT	C	D	E
301:I	2"	14 - 89	12 - 81	3.44	2" - 11 1/2	0.58	1.50	1.90
301:K	3"	21 - 173	19 - 157	4.17	3" - 8	0.95	2.00	2.88
301:M	4"	68 - 391	61 - 355	5.11	4" - 8	1.09	2.50	3.75
301:P	6"	212 - 974	192 - 884	7.72	6" - 8	1.25	4.00	5.56
301:Q	8"	311 - 1374	282 - 1248	8.88	8" - 8	1.44	4.25	7.50

*Contact MGM for flow rates and other fluids